

Specification Sheet

STI-5HI

Daytime Operation

This tamper resistant dome camera contains a 1/3" Sony infrared sensitive HQ1 video sensor that provides high quality video images with auto white balance, auto gain control and automatic backlight compensation in light conditions down to 0.5 Lux. Then Smart IR circuitry activates.



Nighttime Operation

Smart IR circuits control an array of 30 infrared LEDs and turn them on/off in segments as required. When targets get closer to the lens this technology automatically adjusts the amount of IR emitted to avoid washing out the image. A built-in fan keeps internal temperatures down so the IR LEDs can function continually without fear of heat build-up.



With dependable operation during the day and night, you won't need to rely on two different cameras for varying light conditions.

Easy to Aim, Focus, and Adjust

Remove the dome assembly by twisting at the base. Easily access the internal brackets/hinges to point and focus the camera and lens in any direction you require. This also makes it easy to replace the lens or any other components should such operations be required.

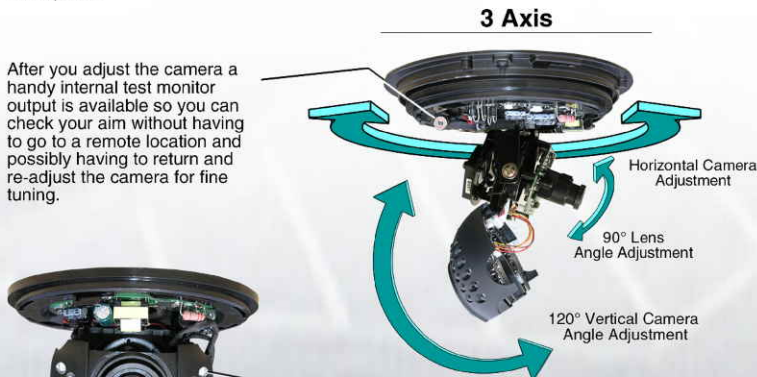

After you adjust the camera a handy internal test monitor output is available so you can check your aim without having to go to a remote location and possibly having to return and re-adjust the camera for fine tuning.



Internal IR LED Array

The infrared LED array transmits IR light in the 850nm wavelength range up to 60 feet (~18.3 meters) from the front of the camera, allowing video images to be picked up by reflected IR light in total darkness (0.0 Lux).



Internal Cooling Fan

A quiet, built-in fan keeps the camera cool and helps to prevent condensation from forming on the inner surface of the dome in all weather conditions, which cuts down on maintenance.



Adjustable Controls

Easy-to-access switch lets you enable/disable auto-electronic shutter and back light compensation, and gives you control over IR delay time (the time it will take from the point when darkness is first detected to the point when the IR array activates).



Anti-Tamper Assembly

When you are satisfied with your settings and adjustments, it's easy to reassemble. Place the dome over the camera and base, twist until the recessed tabs engage, and then replace and tighten the tamper resistant recessed screw with the special tool provided.

General Specifications

Video Sensor:	1/3" Sony HQ1 Infrared Sensitive CCD
# of Pixels:	NTSC - 768(h) x 494(v) PAL - 752(h) x 582(v)
Horizontal Resolution:	540 TV lines
Scanning System:	2:1 Interlace
Light Level Sensitivity:	0.5 Lux (day) / F1.2, (0.0 Lux w/IR on)
Video Signal Synchronization:	Internal
Video Signal Level:	1Vp-p, 75 Ohm impedance
IR LED Array:	30 Units Operating at 850nm Wavelength with selectable delay time.
Signal to Noise Ratio:	>48dB
Gamma Correction:	0.45
Auto-White Balance:	Multi-Color Temperature AWB
Gain Control:	Full Auto-Gain Control (AGC)
Back Light Compensation:	Full Auto BLC
Aperture Correction:	2H mode of H.V
Electronic Shutter:	Auto, 1/60 sec. to 1/100,000 sec.
Dual Power Capable:	12VDC or 24VAC (installers choice) 300mA (nominal), 600mA with IR on

Optical Specifications

Lens: 3.6mm aspherical - prevents focus shift

Environmental Specifications

Operating Temperature:	-10 degrees to +45 degrees (C) 14 degrees to +113 degrees (F)
Storage Temperature:	-30 degrees to +60 degrees (C) -22 degrees to +140 degrees (F)

Physical Specifications

Dim.:	approx . 127mm x 86mm (5" x 3.39")
Weight:	331.1g (0.73lbs)